

See Figure 4.12.2



National Roads Design Office
 Maudlins, Naas, Co. Kildare, Ireland
 Tel: +353-45-898199, Fax: +353-45-875845, e-mail: kcc@kildarenrdo.com

DESMOND PAGE BE, MA, MIEI
 Chartered Engineer
 DIRECTOR of SERVICES
 Transportation & Public Safety

JOHN COPPINGER BE, MIEI
 SENIOR ENGINEER

PROJECT	N81 Hollywood Cross to Tallaght Road Improvement Scheme - Constraints Report
DRAWING	WATER SERVICES (Sheet 1 of 3)
Filename:	N:\PROJECTS\NR0159\DRAWINGS\CONSTRAINTSRE
Dwg.No.	Figure 4.12.1

Scale:	1:25,000 @ A3
Date:	Feb.'09
Drawn by:	RAC
Checked:	WPC
Revision:	

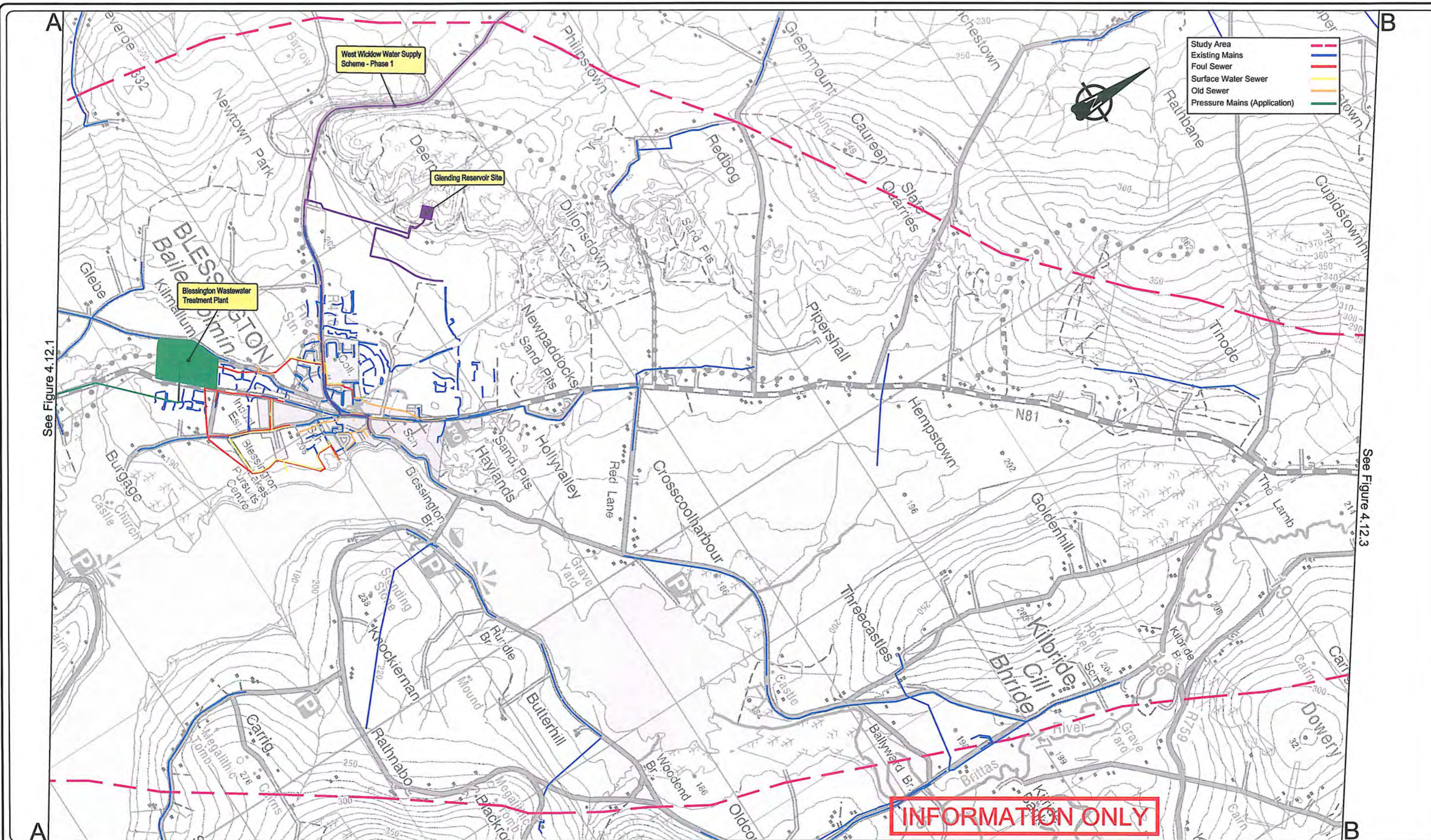

See Figure 4.12.1

See Figure 4.12.3

INFORMATION ONLY

Kildare
County Council



National Roads Design Office
Maudlins, Naas, Co. Kildare, Ireland
Tel: +353-45-898199, Fax: +353-45-875845, e-mail: kcc@kildarenrdo.com

DESMOND PAGE BE, MA, MIEI
Chartered Engineer
DIRECTOR of SERVICES
Transportation & Public Safety

JOHN COPPINGER BE, MIEI
SENIOR ENGINEER

PROJECT	N81 Hollywood Cross to Tallaght Road Improvement Scheme - Constraints Report
DRAWING	WATER SERVICES (Sheet 2 of 3)
Filename:	N:\PROJECTS\NR0159\DRAWINGS\CONSTRAINTSRE
Dwg.No.	Figure 4.12.2

Scale:	1:25,000 @ A3
Date:	Feb.'09
Drawn by:	RAC
Checked:	WPC
Revision:	

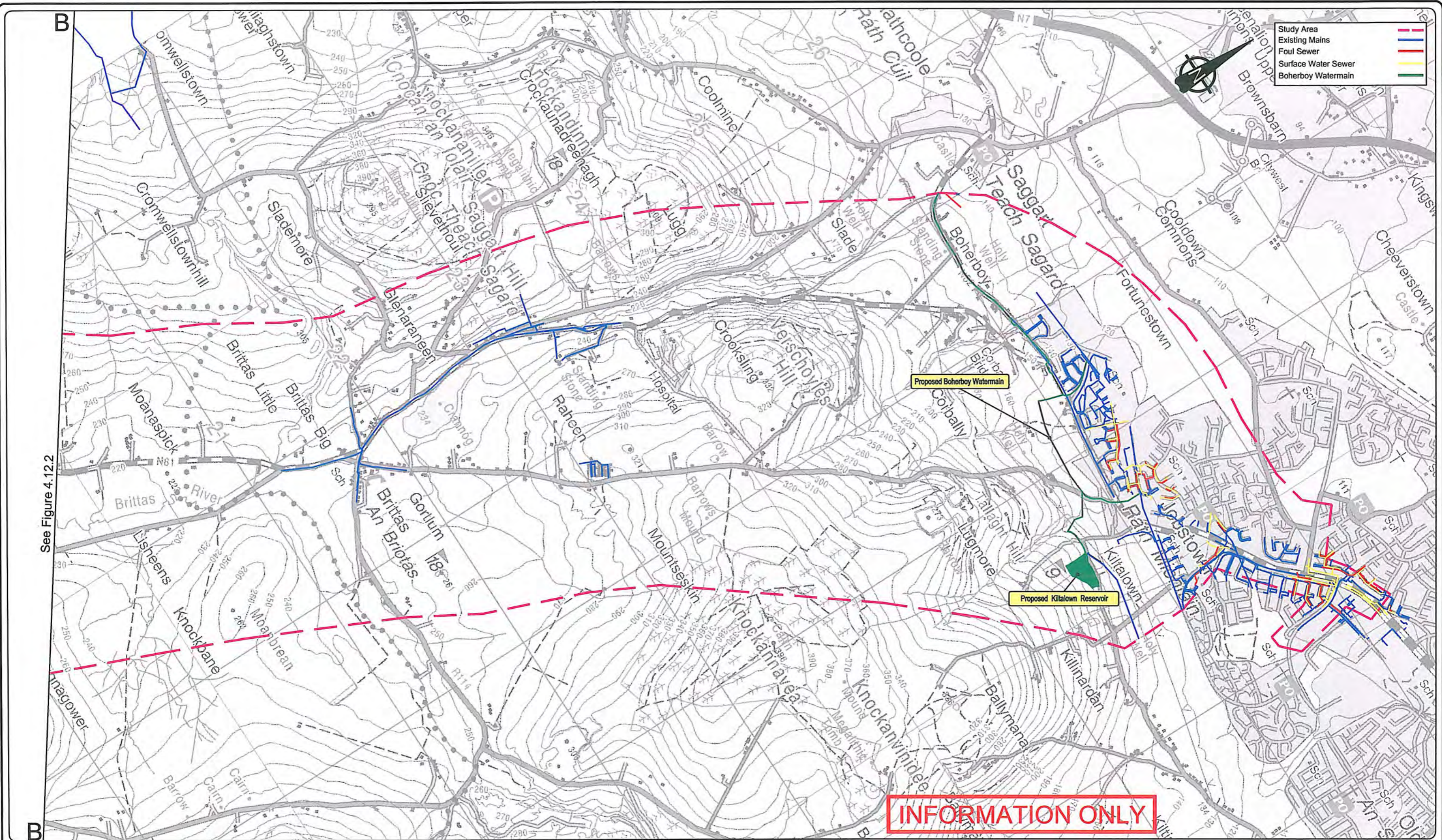

See Figure 4.12.2



National Roads Design Office
 Maudlins, Naas, Co. Kildare, Ireland
 Tel: +353-45-898199, Fax: +353-45-875845, e-mail: kcc@kildarenrdo.com

DESMOND PAGE BE, MA, MIEI
 Chartered Engineer
 DIRECTOR of SERVICES
 Transportation & Public Safety

JOHN COPPINGER BE, MIEI
 SENIOR ENGINEER

PROJECT **N81 Hollywood Cross to Tallaght Road Improvement Scheme - Constraints Report**

DRAWING **WATER SERVICES (Sheet 3 of 3)**

Filename: N:\PROJECTS\NR0159\DRAWINGS\CONSTRAINTSRE Dwg.No. Figure 4.12.3

Scale: 1:25,000 @ A3
 Date: Feb.'09
 Drawn by: RAC
 Checked: WPC
 Revision: