

HGV ACCESS
SCALE 1:500

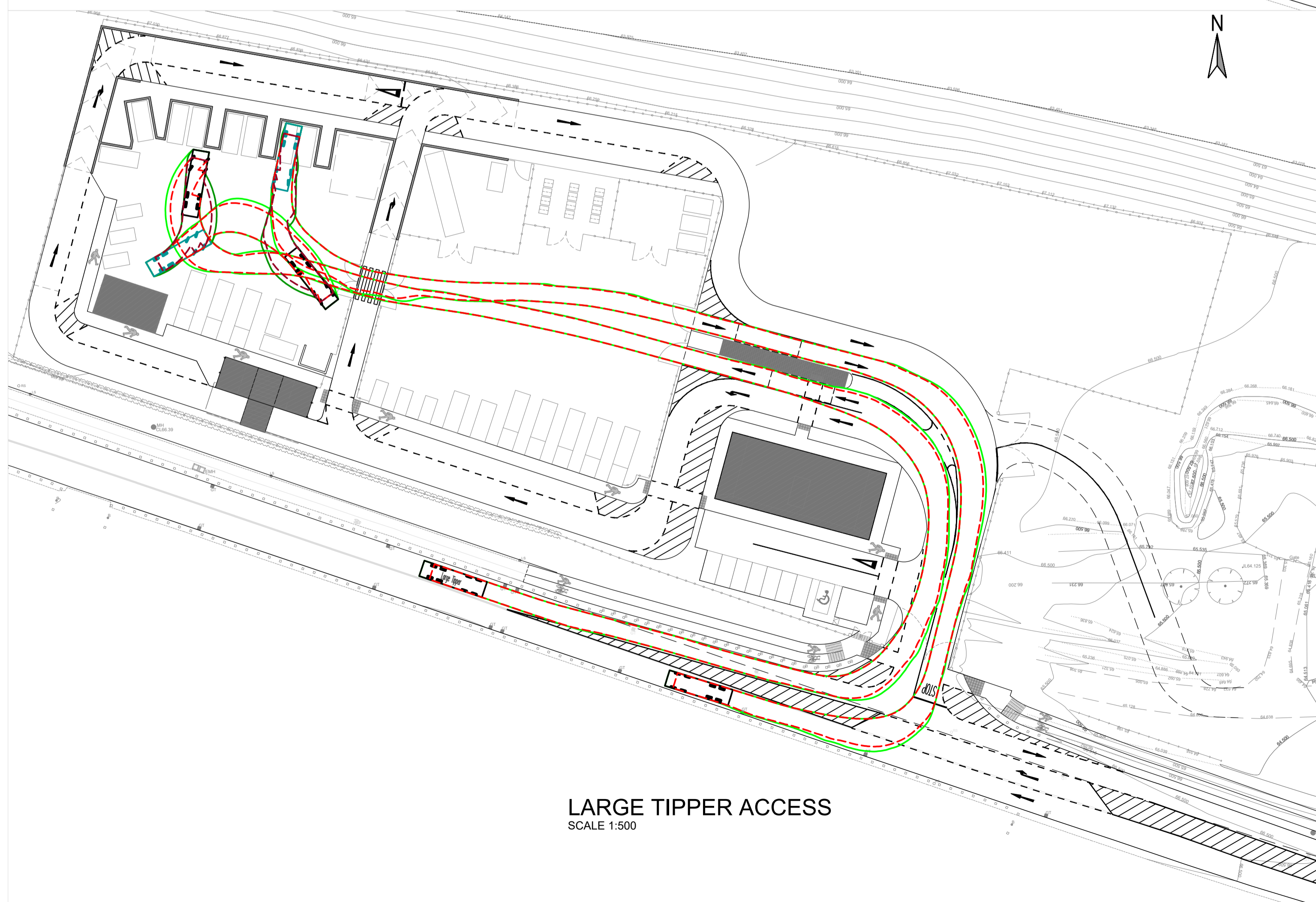

LARGE TIPPER ACCESS
SCALE 1:500

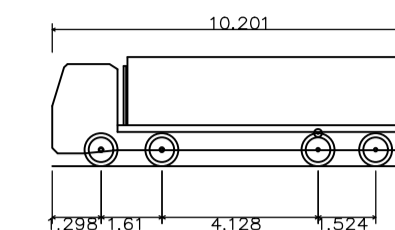

Large Tipper
Overall Length 10.201m
Overall Width 2.500m
Overall Body Height 2.283m
Min Body Ground Clearance 0.343m
Max Track Width 2.500m
Lock to Lock Time 6.00 sec
Kerb to Kerb Turning Radius 11.550m

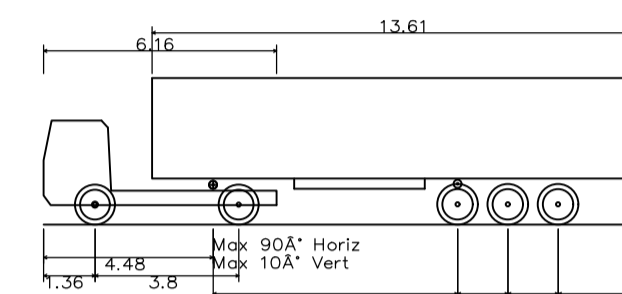

FTA Design Articulated Vehicle (1998)
Overall Length 16.480m
Overall Width 2.550m
Overall Body Height 3.870m
Min Body Ground Clearance 0.515m
Max Track Width 2.470m
Lock to Lock Time 3.00 sec
Kerb to Kerb Turning Radius 6.550m

SWEPT PATH LEGEND

- OUTLINE OF TYRES
- OUTLINE OF CARRIAGE
- OUTLINE OF TYRES (REVERSING)
- OUTLINE OF CARRIAGE (REVERSING)

ISSUED FOR PLANNING

S2.P03	ISSUED FOR PLANNING	22.02.2019	KD	PD
S2.P02	ISSUED FOR INFORMATION	17.12.2018	KD	PD
S2.P01	ISSUED FOR INFORMATION	05.11.2018	KD	PD
Rev.	Note	Date	Drawn	Check

DONNACHADH O'BRIEN
& ASSOCIATES CONSULTING ENGINEERS

UNIT 5C
ELM HOUSE
MILLENNIUM PARK
NAAS
CO. KILDARE

PHONE
+353 45 984 042

INFO@DOBRIEN-ENGINEERS.IE
WWW.DOBRIEN-ENGINEERS.IE

Client: KILDARE COUNTY COUNCIL
Comhairle Chontae Chill Dara
MR. JOE BOLAND, DIRECTOR OF SERVICES
WATER SERVICES & ENVIRONMENT



Project: PROPOSED CIVIC AMENITY CENTRE
& WASTE TRANSFER FACILITY AT KILMACREDDOCK UPPER,
CASTLETOWN, CELBRIDGE, Co. KILDARE

Drawing Title: PROPOSED AUTOTRACK ACCESS - SHEET 1

Drawn By: KD	Checked By: PD	Approved By: DOB	Date: APR 2018	Scale: 1:500	Sheet Size: A1
Project Number: DOBA1701	Drawing Number: CIVAMY-DOB-XX-SI- DR-C-0070	Status Code: S2	Rev Number: P03		