

**Typical Proposed Residential Road - Extension**  
Scale 1:25

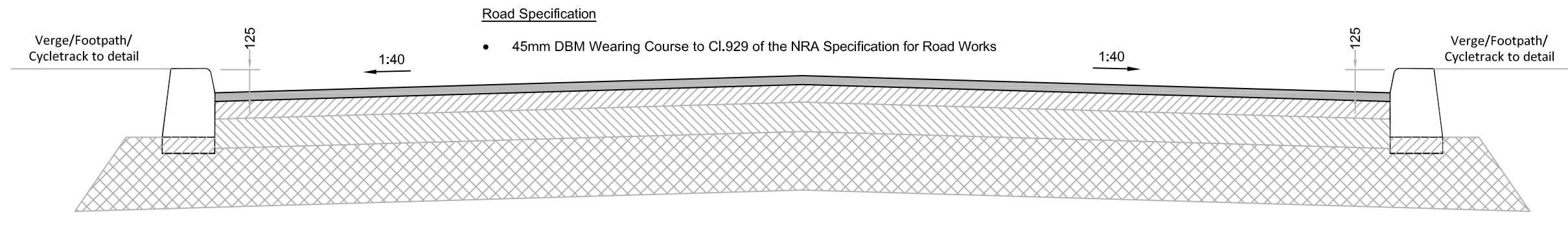

**Typical Existing Residential Road - Overlay**  
Scale 1:25

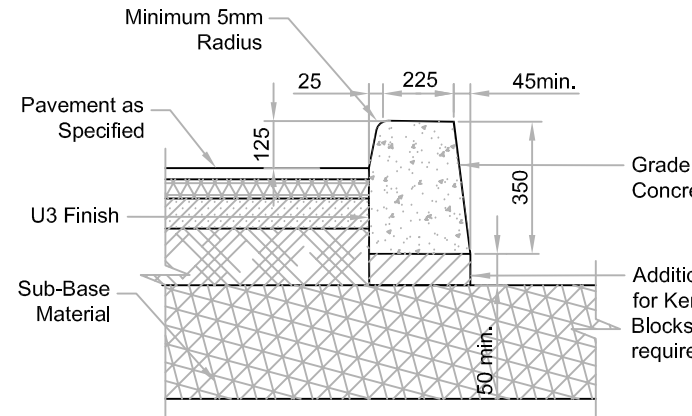

**Typical Section through In-situ Slipform Concrete Kerb Type A**  
Scale 1:20

Where vehicular access is to be provided Kerbs shall have a height of 25mm above the Channel Level. There shall be a 1m long transitional length of Kerb between Kerbs of standard height and 25mm high Kerbs

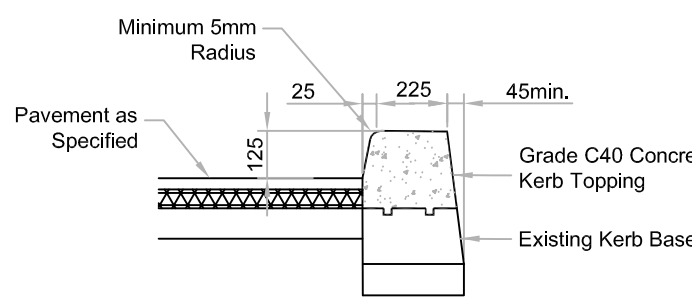

**Typical Section through In-situ Slipform Concrete Kerb Type B**  
Scale 1:20

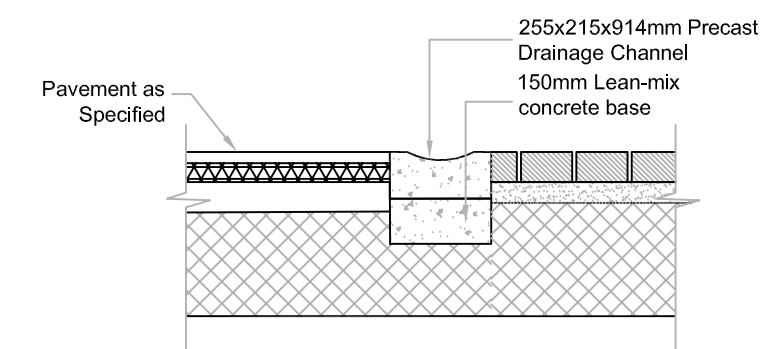

**Typical Section through Precast Channel Type C**  
Scale 1:20

**ROAD SPECIFICATION FOR ACCESS ROADS:**

- All Granular fill Capping and Road Base to be certified for end use to the requirements of SRZ1 as above. Each layer shall be compacted with approved mechanical equipment in accordance with clause 6'12 of the NRA Specification. Generally the layers shall not exceed 150mm thick.
- Granular fill shall be obtained from an independently tested and approved quarry. The stone shall be certified as being not subject to swelling
- CBR tests to be carried out at a maximum of 100 m.c.c.
- Terram or similar approved may be required for low CBR values.
- All materials used in the Road Construction shall have a CE mark and shall be installed as per the manufactures specification.

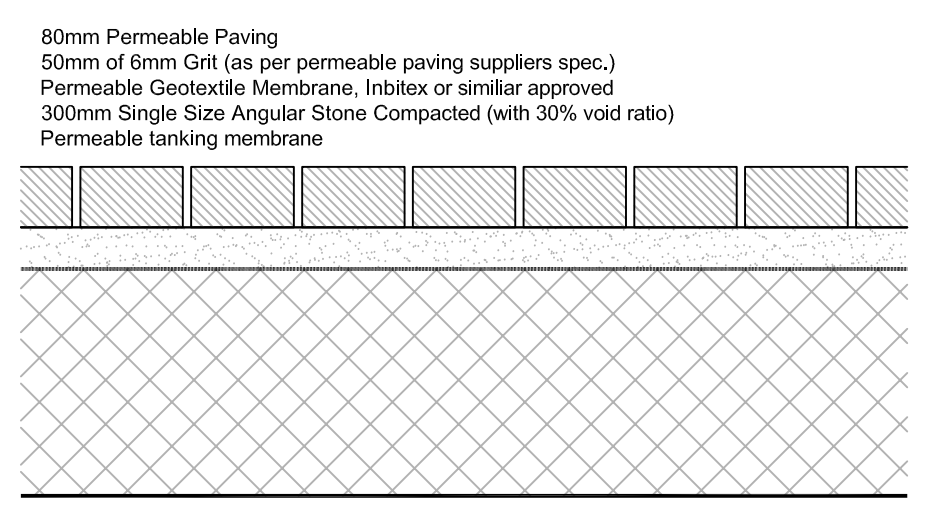
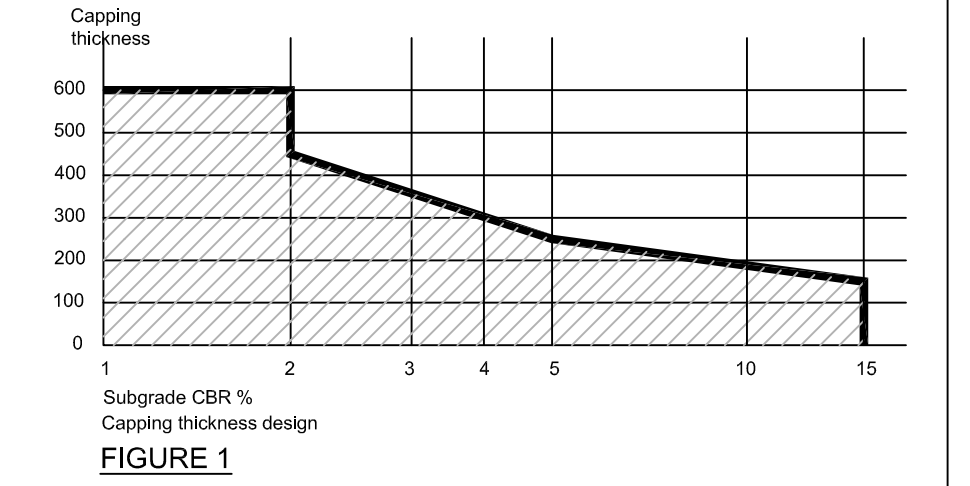

**Permeable Paving (Parking)**  
Scale 1:10

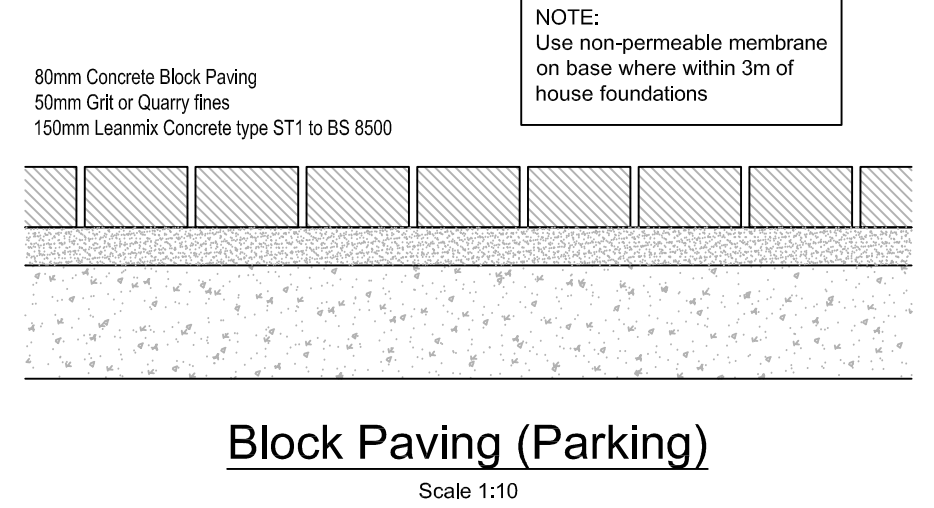

**Block Paving (Parking)**  
Scale 1:10

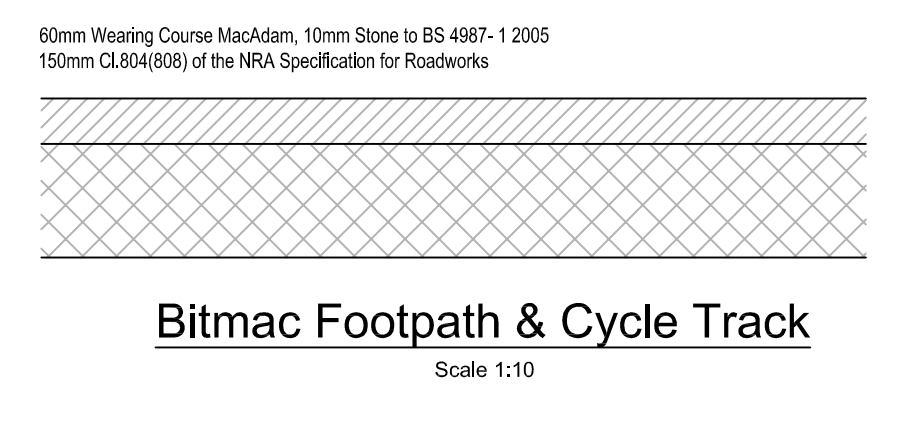

**Bitmac Footpath & Cycle Track**  
Scale 1:10

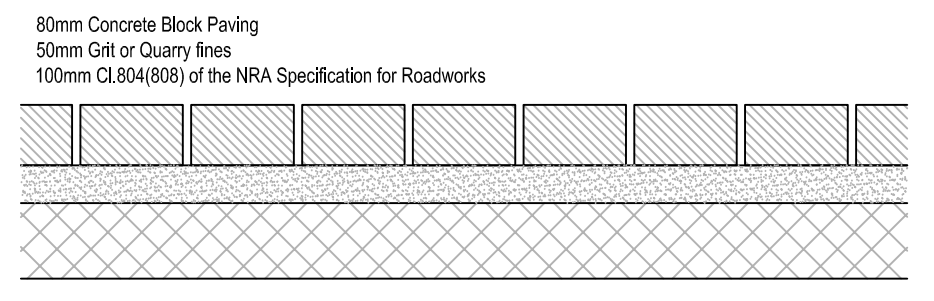

**Block Paving (Non Parking)**  
Scale 1:10

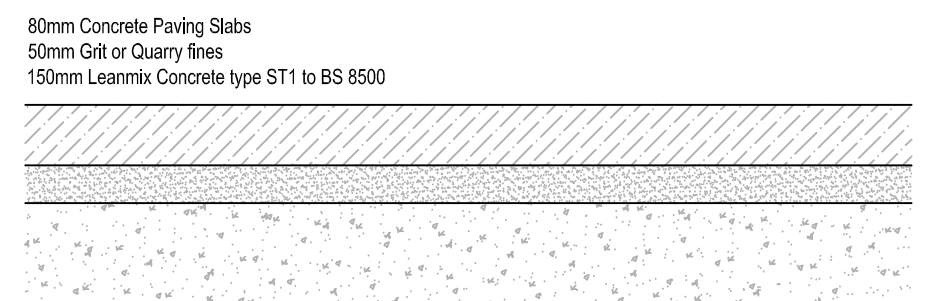

**Paving Slab (Parking)**  
Scale 1:10

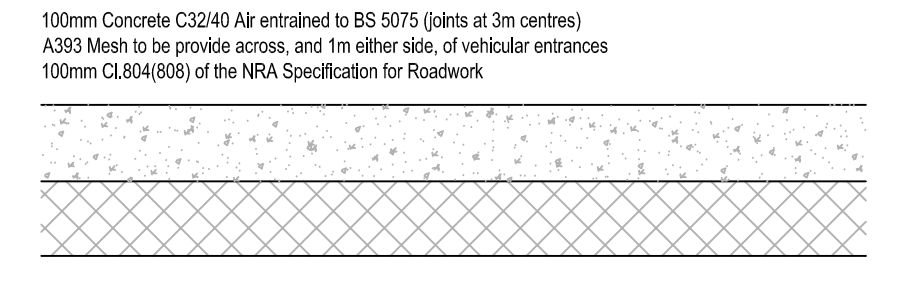

**Concrete Path**  
Scale 1:10

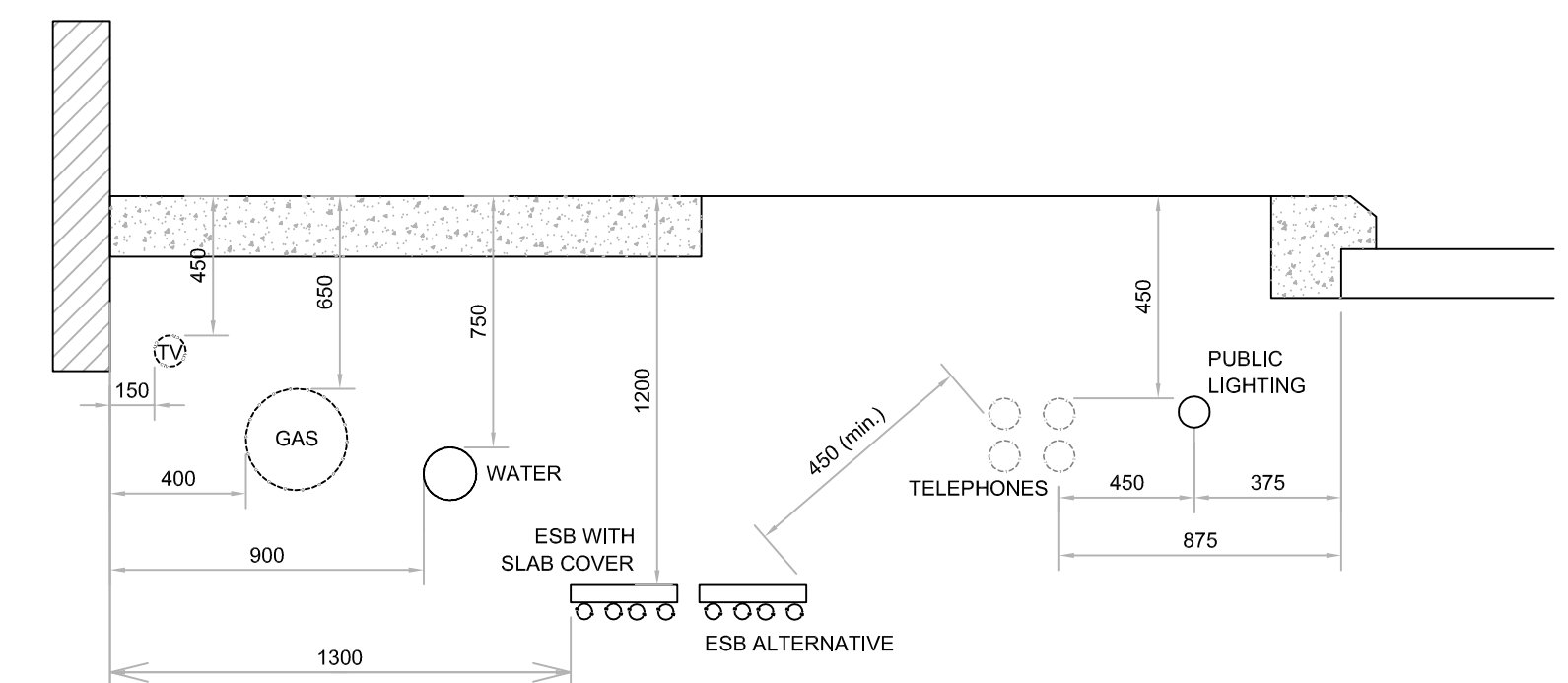

**Typical Below Ground Services Layout Requirements**  
Scale 1:25

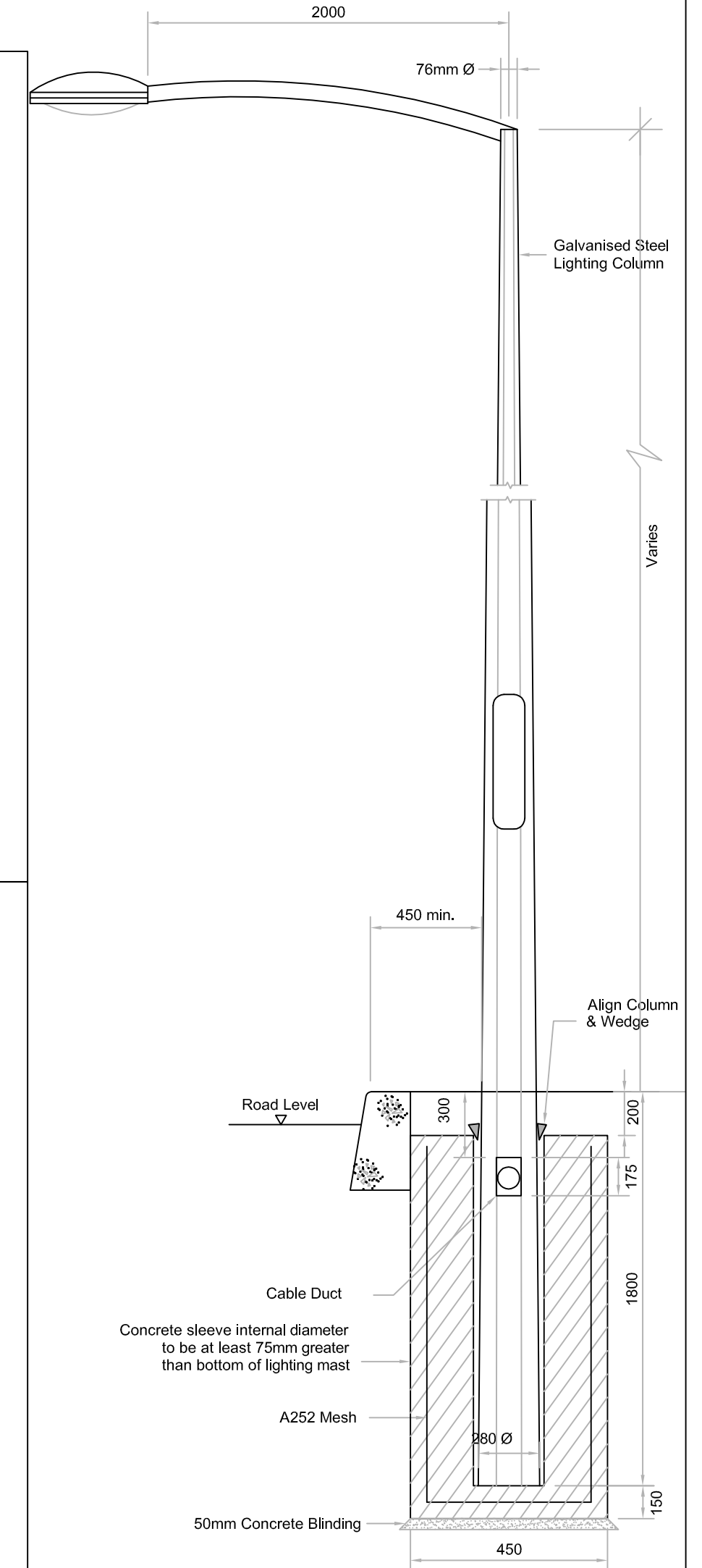

**Elevation of Typical Lamp**  
Scale 1:25

REV.	DATE	DESCRIPTION	BY

**PAT O'GORMAN & ASSOCIATES**  
Consulting Structural and Civil Engineers  
Unit C2, Nutgrove Office Park, Rathfarnham, Dublin 14.  
Tel: +353 1 205 1101 Fax: +353 1 205 1102  
E-mail: info@pogorman.ie www.pogorman.ie

**PROJECT**  
**PROSPEROUS**  
**DRAWING TITLE**  
**STANDARD ROADS DETAILS**

ARCHITECT		STAGE	
MCORM		<b>PART 8</b>	
DATE	CHECKED	DRAWN	SCALES
FEB 2017	PM	CB	AS SHOWN
DWG NO.	REV.	1642-105	
	0		

