

A1

DO NOT SCALE

File: 5155640_HTR_DR_0123.dwg
Date: Aug 28, 2024 - 10:04am
Plotted by: R.earghy

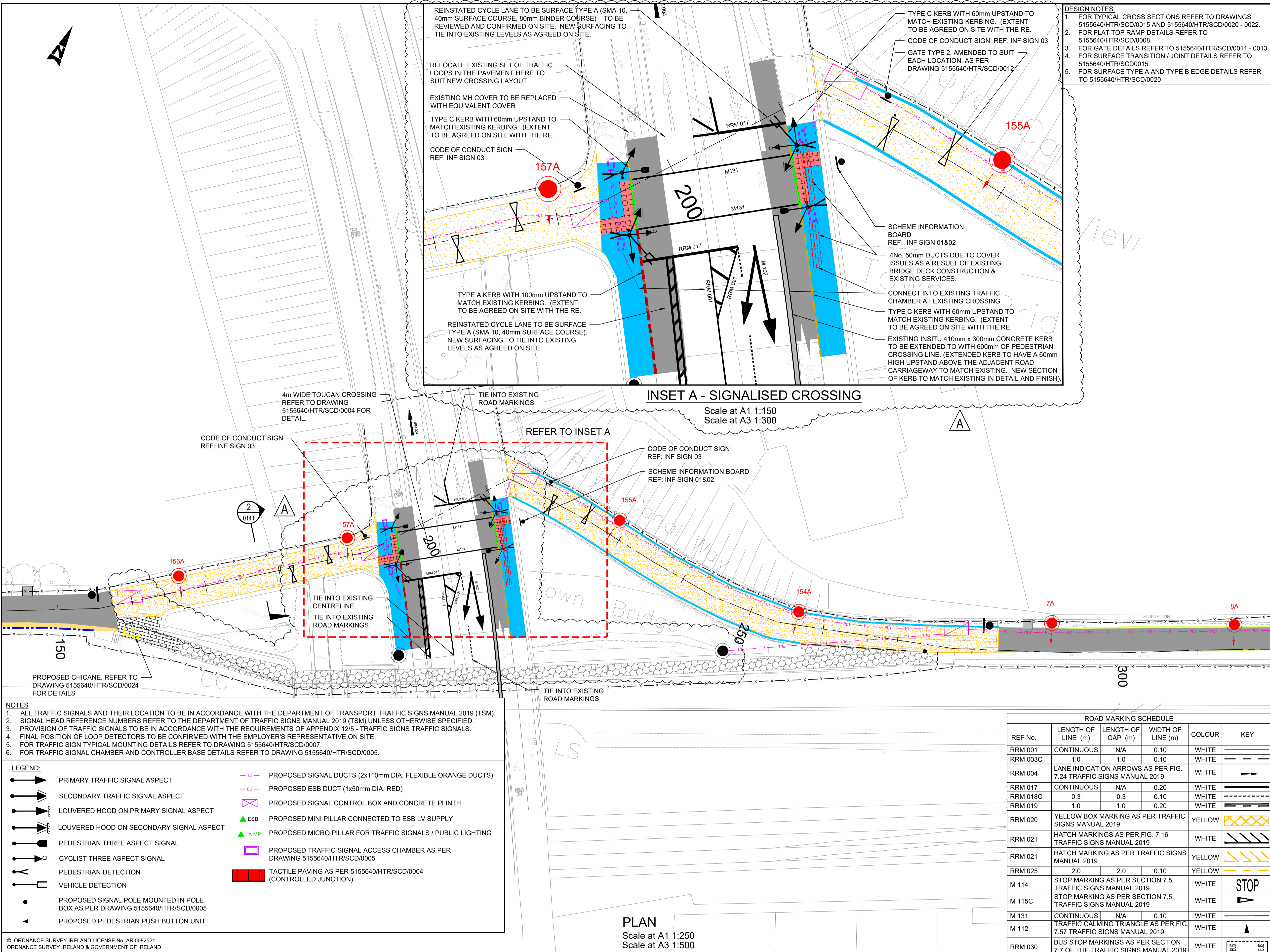

- NOTES
1. ALL TRAFFIC SIGNALS AND THEIR LOCATION TO BE IN ACCORDANCE WITH THE DEPARTMENT OF TRANSPORT TRAFFIC SIGNS MANUAL 2019 (TSM).
 2. SIGNAL HEAD REFERENCE NUMBERS REFER TO THE DEPARTMENT OF TRANSPORT TRAFFIC SIGNS MANUAL 2019 (TSM) UNLESS OTHERWISE SPECIFIED.
 3. PROVISION OF TRAFFIC SIGNALS TO BE IN ACCORDANCE WITH THE REQUIREMENTS OF APPENDIX 12/5 - TRAFFIC SIGNS TRAFFIC SIGNALS.
 4. FINAL POSITION OF LOOP DETECTORS TO BE CONFIRMED WITH THE EMPLOYER'S REPRESENTATIVE ON SITE.
 5. FOR TRAFFIC SIGN TYPICAL MOUNTING DETAILS REFER TO DRAWING 5155640/HTR/SCD/0007.
 6. FOR TRAFFIC SIGNAL CHAMBER AND CONTROLLER BASE DETAILS REFER TO DRAWING 5155640/HTR/SCD/0005.

- LEGEND:
- PRIMARY TRAFFIC SIGNAL ASPECT
 - SECONDARY TRAFFIC SIGNAL ASPECT
 - LOUVERED HOOD ON PRIMARY SIGNAL ASPECT
 - LOUVERED HOOD ON SECONDARY SIGNAL ASPECT
 - PEDESTRIAN THREE ASPECT SIGNAL
 - CYCLIST THREE ASPECT SIGNAL
 - PEDESTRIAN DETECTION
 - VEHICLE DETECTION
 - PROPOSED SIGNAL POLE MOUNTED IN POLE BOX AS PER DRAWING 5155640/HTR/SCD/0005
 - PROPOSED PEDESTRIAN PUSH BUTTON UNIT
 - PROPOSED SIGNAL DUCTS (2x110mm DIA. FLEXIBLE ORANGE DUCTS)
 - PROPOSED ESB DUCT (1x50mm DIA. RED)
 - PROPOSED SIGNAL CONTROL BOX AND CONCRETE PLINTH
 - PROPOSED MINI PILLAR CONNECTED TO ESB LV SUPPLY
 - PROPOSED MICRO PILLAR FOR TRAFFIC SIGNALS / PUBLIC LIGHTING
 - PROPOSED TRAFFIC SIGNAL ACCESS CHAMBER AS PER DRAWING 5155640/HTR/SCD/0005
 - TACTILE PAVING AS PER 5155640/HTR/SCD/0004 (CONTROLLED JUNCTION)

© ORDNANCE SURVEY IRELAND LICENSE No. AR 0082521.
ORDNANCE SURVEY IRELAND & GOVERNMENT OF IRELAND



\\SIEDBAF01\\Project-Data\\5155640\\6 Dwg-Graphics\\61 AutoCad\\5155640_HTR_DR_0123.dwg

INSET A - SIGNALISED CROSSING

Scale at A1 1:150
Scale at A3 1:300

PLAN
Scale at A1 1:250
Scale at A3 1:500

- DESIGN NOTES:
1. FOR TYPICAL CROSS SECTIONS REFER TO DRAWINGS 5155640/HTR/SCD/0015 AND 5155640/HTR/SCD/0020 - 0022.
 2. FOR FLAT TOP RAMP DETAILS REFER TO 5155640/HTR/SCD/0008.
 3. FOR GATE DETAILS REFER TO 5155640/HTR/SCD/0011 - 0013.
 4. FOR SURFACE TRANSITION / JOINT DETAILS REFER TO 5155640/HTR/SCD/0015.
 5. FOR SURFACE TYPE A AND TYPE B EDGE DETAILS REFER TO 5155640/HTR/SCD/0020

- GENERAL NOTES
1. ALL DIMENSIONS ARE IN MILLIMETRES UNLESS NOTED OTHERWISE
 2. ONLY WRITTEN DIMENSIONS SHALL BE USED. NO DIMENSIONS SHALL BE SCALED FROM THE DRAWINGS
 3. ALL LEVELS ARE IN METRES AND ARE TO MALIN HEAD DATUM
 4. ALL COORDINATES ARE IN METRES AND ARE TO IRISH TRANSVERSE MERCATOR
 5. DRAWINGS ARE TO BE READ IN CONJUNCTION WITH THE SPECIFICATION

- LEGEND
- EXTENT OF WORKS
 - SURFACE A: PROPOSED BITUMINOUS SURFACED GREENWAY, TO APPENDIX 7/1
 - SURFACE B: PROPOSED GRIT SURFACE, TO APPENDIX 7/1
 - SURFACE C: RESURFACED GRIT SURFACE, TO APPENDIX 7/1
 - SURFACE D: PROPOSED BITUMINOUS INLAY TO APPENDIX 7/1
 - SURFACE E: PROPOSED BITUMINOUS INLAY TO APPENDIX 7/1
 - SURFACE F: PROPOSED BITUMINOUS INLAY TO APPENDIX 7/1
 - TACTILE PAVING AS PER 5155640/HTR/SCD/0004 (UNCONTROLLED JUNCTION)
 - TACTILE PAVING AS PER 5155640/HTR/SCD/0004 (LADDER & TRAMLINE)
 - RESIN BOUND ANTI-SKID STRIP (BUFF IN COLOR)
 - NARROWED / WIDENED GREENWAY
 - BITUMINOUS FOOTWAY TO APPENDIX 11/1
 - PROPOSED EARTHWORKS / VERGE
 - EXISTING SURFACED AREA TO BE RETAINED
 - RE-INSTALL PAVING BLOCKS
 - ROYAL CANAL
 - PROPOSED CONCRETE FOOTWAY / BUILD-OUT TO APPENDIX 11/1
 - EXISTING KERB TO BE RETAINED
 - TYPE A PRECAST CONCRETE KERB TO CC-SCD-01101 (WITH 125mm UPSTAND)
 - TYPE A PRECAST CONCRETE KERB TO CC-SCD-01101 (WITH 75mm UPSTAND)
 - PRECAST CONCRETE KERB TO CC-SCD-01101 (TRANSITION 80mm / 125mm TO 0mm UPSTAND)
 - TYPE A PRECAST CONCRETE KERB TO CC-SCD-01101 (WITH 160mm UPSTAND)
 - TYPE C PRECAST CONCRETE KERB TO CC-SCD-01101 (WITH 80mm UPSTAND SPLAYED AT 45 DEG.)
 - TYPE D PRECAST DROPPED KERB TO CC-SCD-01103 (WITH 0mm UPSTAND)
 - VEHICULAR DROPPED KERB (25mm UPSTAND)
 - RANDOM RUBBLE MASONRY CAPPING TO EXISTING HARBOUR WALL, TO APPENDIX 24/1
 - KASSEL KERB AS PER DRAWING 5155640/HTR/SCD/0015. (160mm UPSTAND)
 - HEDGE - TO APPENDIX 30/1
 - PROPOSED TRAFFIC SIGNS, TO APPENDIX 12/1
 - PROPOSED VERGE DELINEATORS TO APPENDIX 12/2 OF THE SPECIFICATION
 - PENCIL BOLLARDS TO APPENDIX 12/2
 - PROPOSED TIMBER POST & RAIL FENCE TO TII CC-SCD-00301
 - PROPOSED TIMBER POST AND TENSION MESH FENCE TO TII CC-SCD-00320
 - PROPOSED RAILING TYPE 1 TO APPENDIX 4/2
 - PROPOSED RAILING TYPE 2 TO APPENDIX 4/2 OF
 - PEDESTRIAN GUARDRAIL TO APPENDIX 4/2
 - PROPOSED GREENWAY GATE
 - SINGLE STEEL FIELD GATE TO TII-SCD-00309 (TYPE Z)
 - PB PROPOSED PARK BENCH AS PER APPENDIX 30/2
 - FS RELOCATED FISHING STAND
 - MEM RELOCATED MEMORIAL
 - PT PROPOSED PICNIC TABLE AS PER APPENDIX 30/2
 - CC PROPOSED CYCLE COUNTERS AS PER APPENDIX 30/2
 - MR PROPOSED MOORING RING TO APPENDIX 30/2
 - CS PROPOSED CYCLE STANDS TO APPENDIX 30/2
 - CRS PROPOSED CYCLE REPAIR STAND AS PER APPENDIX 30/2
 - LB PROPOSED LITTER BIN AS PER APPENDIX 30/2
 - PROPOSED LIGHTING COLUMNS AS PER APPENDIX 13/1 (TYPE A)
 - PROPOSED LIGHTING COLUMN (ROOTING ONLY) AS PER APPENDIX 13/1 (TYPE A)
 - PROPOSED LIGHTING UNITS AS PER APPENDIX 13/1 (TYPE B)
 - PROPOSED LIGHTING COLUMN AS PER APPENDIX 13/1 (TYPE C)
 - PROPOSED LIGHTING COLUMN AS PER APPENDIX 13/1 (TYPE E)
 - PROPOSED LIGHTING COLUMN AS PER APPENDIX 13/1 (TYPE F)
 - PROPOSED LIGHTING COLUMN AS PER APPENDIX 13/1 (TYPE G)
 - PROPOSED TABLE TOP RAMP

ROAD MARKING SCHEDULE					
REF No.	LENGTH OF LINE (m)	LENGTH OF GAP (m)	WIDTH OF LINE (m)	COLOUR	KEY
RRM 001	CONTINUOUS	N/A	0.10	WHITE	—
RRM 003C	1.0	1.0	0.10	WHITE	— —
RRM 004	LANE INDICATION ARROWS AS PER FIG. 7.24 TRAFFIC SIGNS MANUAL 2019			WHITE	→
RRM 017	CONTINUOUS	N/A	0.20	WHITE	—
RRM 018C	0.3	0.3	0.10	WHITE	— — — —
RRM 019	1.0	1.0	0.20	WHITE	— — — —
RRM 020	YELLOW BOX MARKING AS PER TRAFFIC SIGNS MANUAL 2019			YELLOW	□
RRM 021	HATCH MARKINGS AS PER FIG. 7.16 TRAFFIC SIGNS MANUAL 2019			WHITE	▨
RRM 021	HATCH MARKING AS PER TRAFFIC SIGNS MANUAL 2019			YELLOW	▨
RRM 025	2.0	2.0	0.10	YELLOW	— — — —
M 114	STOP MARKING AS PER SECTION 7.5 TRAFFIC SIGNS MANUAL 2019			WHITE	STOP
M 115C	STOP MARKING AS PER SECTION 7.5 TRAFFIC SIGNS MANUAL 2019			WHITE	▴
M 131	CONTINUOUS	N/A	0.10	WHITE	—
M 112	TRAFFIC CALMING TRIANGLE AS PER FIG. 7.57 TRAFFIC SIGNS MANUAL 2019			WHITE	▴
RRM 030	BUS STOP MARKINGS AS PER SECTION 7.7 OF THE TRAFFIC SIGNS MANUAL 2019			WHITE	▴

Purpose FOR CONSTRUCTION

KILDARE COUNTY COUNCIL				GENERAL ARRANGEMENT STRAFFAN ROAD BRIDGE			
THE ROYAL CANAL GREENWAY MAYNOOTH TO CONFEEY				Original Scale	Design/Drawn	Checked	Authorised
				AS SHOWN	KH	DR	UOH
				Date	18.06.21	Date	18.06.21
				Status	Drawing Number		Rev
C				5155640 / HTR / DR / 0123			A

Rev	Description	By	Date	Chk'd	Auth
A	REVISIONS AS CLOUDED	RG	21.08.24	DR	DM
-	ISSUED FOR CONSTRUCTION	RG	12.04.24	DR	DM

Atkins House, 150-155 Airside Business Park, Swords, Co. Dublin
Tel (+353) 01 810 8000
Fax (+353) 01 810 8001

Unit 2B, 2200 Cork Airport Business Park, Cork
Tel (+353) 021 429 0300
Fax (+353) 021 429 0360

1st Floor Technology House Parkmore Technology Park, Galway
Tel (+353) 091 786 050
Fax (+353) 091 779 830